

GMDM-I

Multi jet-super dry Soğuk & Sıcak Su Sayaçları



Versiyon Sıcak Su
30-90°C
Available version
for hot water 30-90°C

ITA mod. GMDM-I

Getto multiplo, quadrante asciutto, trasmissione magnetica con coperchio girevole a 360°.
Versione per acqua fredda (50°C) e acqua calda (90°C).
Predisposizione induttiva per l'installazione di moduli di trasmissione dati M-BUS cablati, wireless OMS e lancia impulsi di tipo amagnetico.

TR mod. GMDM-I

Multi-jet, kuru kadran, 360°
Dönen kapaklı manyetik şanzıman.
Soğuk su (50 ° C) ve sıcak su (90 ° C) için versiyonlar. İndüktif ön ekipman veri iletişim modüllerinin kurulumu için M-BUS kablolu ve kablosuz OMS ve Manyetik olmayan puls çıkışı.

ENG mod. GMDM-I

Multi-jet, dry dial, magnetic transmission with 360° rotating lid.
Versions for cold water (50°C) and hot water (90°C).
Inductive pre-equipment for the installation of data communication modules M-BUS wired and wireless OMS and non-magnetic pulse output.

FRA mod. GMDM-I

Jet multiple, cadran sec, entrainement magnétique avec capot orientable à 360°.
Version pour eau froide (50°C) et eau chaude (90°C).
Pre-équipement inductif pour modules de télérelèvement M-Bus filaire et radio OMS et avec émetteur d'impulsions amagnétique.

Kullanılabilir Modüller
Available modules

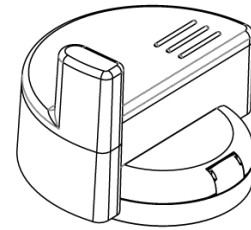

mod. IWM-TX3

M-Bus
wireless

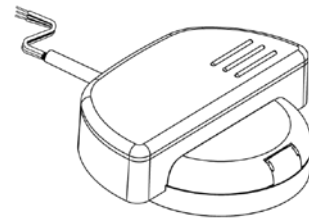

mod. IWM-MB3
mod. IWM-PL3

M-Bus PULSE

Çap Size	DN	mm in	15 (1/2")	20 (3/4")	25 (1")	32 (1 1/4")	40 (1 1/2")	50 (2")	
Maksimum Debi Overload flow rate	Q ₄	m ³ /h	3,125	5	7,875	12,5	20	31,25	
	Nominal Debi Permanent flow rate	Q ₃	m ³ /h	2,5	4	6,3	10	16	25
R=100 H ↑	Geçiş Debisi Transitional flow rate	Q ₂	l/h	40	64	100,8	160	256	400
	Minimum Debi Min flow rate	Q ₁	l/h	25	40	63	100	160	250
R=160 H ↑*	Geçiş Debisi Transitional flow rate	Q ₂	l/h	25	40	63	100	160	250
	Minimum Debi Min flow rate	Q ₁	l/h	15,63	25	39,38	62,5	100	156,25
R=50 VH →	Geçiş Debisi Transitional flow rate	Q ₂	l/h	80	128	201,6	320	512	800
	Minimum Debi Min flow rate	Q ₁	l/h	50	80	126	200	320	500
Hassasiyet Sensitivity	%		2	2	2	2	2	2	
	Minimum Okuma Min reading	l	0,05	0,05	0,05	0,05	0,05	0,05	
	Maksimum Okuma Max reading	m ³	99.999	99.999	99.999	99.999	999.999	999.999	
	Çalışma Basıncı Max admissible pressure MAP	bar	16	16	16	16	16	16	

*Soğuk Su Modelleri içindir.

*Version on request only cold water

Boyutlar ve Ağırlıklar - *Dimensions and Weights*

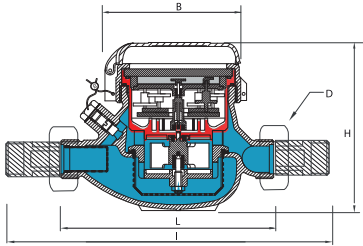

Çap Size	mm in	15 (1/2")	20 (3/4")	25 (1")	32 (1 1/4")	40 (1 1/2")	50 (2")
L	mm	145-165-190	190	260	260	300	300
l	mm	225-245-270	290	360	380	440	460
H	mm	109	111	117	117	153	172
B	mm	100	100	104	104	126	160
D ^{Filettatura} Threading	mm	3/4"	1"	1 1/4"	1 1/2"	2"	2 1/2"
Ağırlık Weight	kg	1,18 1,41	1,40	2,09	2,18	4,38	4,46 9,40

Sayaç Diş Bağlantı Standart - Threading EN ISO 228-1:2003

DN 50 Flanş Standart ISO 7005-2 / EN 1092-2 PN16

İstek üzerine DN50 Flanş Ayarlanabilir Standart ISO 7005-2 / EN 1092-2 PN16

Standart Sürüm - *Basic version*

- R100-H ↑ R50-VH →
- Soğuk Model 0°C-50°C
- Sıcak Model 30°C-90°C
- Manyetik Puls Aktarma
- 5 Dijit Mekanik Okuma (DN40 ve DN50 6 Dijit Mekanik Okuma)
- Kuru Tip Kadran
- 360° Dönebilen Kapak (DN15-DN32)

- R100-H ↑ R50-VH →
- Cold water version 0°C-50°C
- Hot water 30°C-90°C
- Magnetic transmission
- Direct reading on 5 numeric rolls (6 numeric rolls on DN40 and DN50)
- Dry dial
- 360° rotating lid (DN15-DN32)

İstek üzerine - *Upon request*

- Soğuk Su Sürümü R160-H ↑ R50-VH → için anti manyetik koruma
- Cold water version R160-H ↑ R50-VH →
- Anti-magnetic fraud protection

Kurulum Pozisyonu - *Installation position*

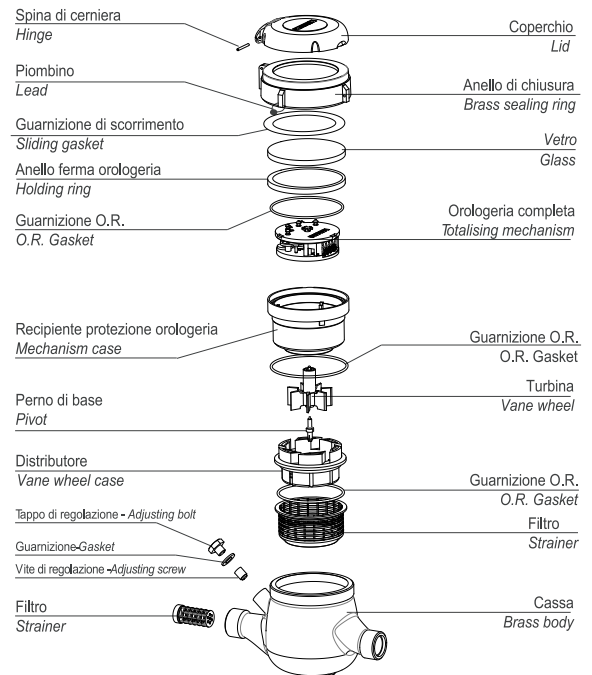
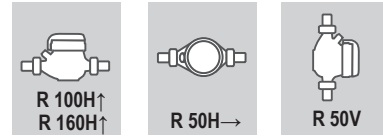

www.baysaelektronik.com
info@baysaelektronik.com
muhammed@baysaelektronik.com

Hocacihan Mh. Madendağı Sk.
Selçuklu / KONYA

+90 (507) 310 84 23